



MARINA WALK ON ONE PARTICULAR HARBOUR

ANNA MARIA SOUND, FL



SITE PLAN & AMENITIES



SITE PLAN & AMENITIES

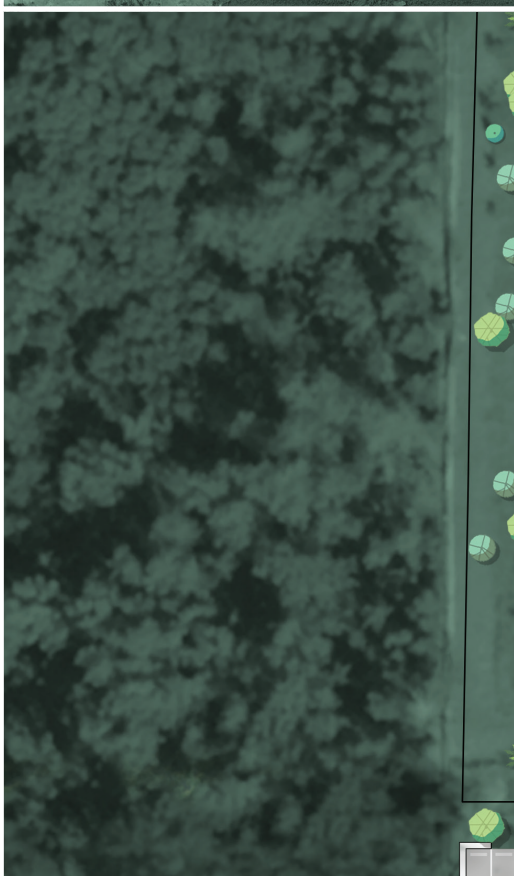

© Minto Communities, LLC 2017. All rights reserved. Content may not be reproduced, copied, altered, distributed, stored or transferred in any form or by any means without express written permission. Artist's renderings, dimensions, specifications, prices and features are approximate and subject to change without notice.

ORAL REPRESENTATIONS CANNOT BE RELIED UPON AS CORRECTLY STATING REPRESENTATIONS OF THE DEVELOPER. FOR CORRECT REPRESENTATIONS, MAKE REFERENCE TO THIS BROCHURE AND TO THE DOCUMENTS REQUIRED BY SECTION 718.503, FLORIDA STATUTES, TO BE FURNISHED BY A DEVELOPER TO A BUYER OR LESSEE.



Minto, the Minto logo, One Particular Harbour and the One Particular Harbour logo are trademarks of Minto Communities, LLC, and/or its affiliates. CGC1519880. 5/17



INTRACOASTAL WATERWAY
Project Depth
9 feet Caloosahatchee River, Fla. to Anclote River, Fla.
The controlling depths are published periodically in the U.S. Coast Guard Local Notice to Mariners.

Distances
The Waterway is indicated by a magenta line. Mileage distances shown along waterway are in Statute Miles, based on zero at the junction with the Okeechobee Waterway in San Carlos Bay, Florida.
Tables for converting Statute Miles to International Nautical Miles are given in U.S. Coast Pilot 5.

(941) 896-4826
OPHMintoUSA.com

12300 Manatee Avenue West | Bradenton, FL 34209
On SR-64 West, just before the Anna Maria Island Bridge



MOPH-001991_03 2M 5/2017

PALMA SOLA BAY